



NEIGHBORHOOD

Hollywood is a European-style getaway nestled between Fort Lauderdale and Miami Beach. The beaches and Intracoastal Waterway are home to the best waterfront experiences. Conveniently located in proximity to both Fort Lauderdale and Miami International airports, 10 minutes away from Bal Harbour Shops and 25 minutes away from renowned and famous South Beach, Hollywood Beach's unique diversity has converted this destination into a city rich with culture and flare that is unparalleled in the world today.

SALES INFORMATION

For more information on Trump Hollywood, please call 866.382.4540 or visit www.trumphollywood.com

ON-SITE SALES CENTER OPEN DAILY
2711 South Ocean Drive, Hollywood Beach, Florida 33019
866.382.4540 | www.trumphollywood.com

Sales by **Related Realty** in collaboration with **Fortune Development Sales**.



Oral representation cannot be relied upon as correctly stating the representations of the developer. For correct representations should be made to the documents required by section 718.503 Florida Statutes, to be furnished by a developer to a buyer or lessee. This offering is made only by the prospectus for the condominium and no statement should be relied upon if not made in the prospectus. This is not an offer to sell, or solicitation of offers to buy, the condominium units in estates where such offer or solicitation cannot be made. Prices, features, and specifications subject to change without notice. Model furniture not included in asking price. Trump Hollywood is not owned, developed or sold by Donald J. Trump, the Trump Organization, or any of their affiliates. TRG Holiday Ltd., the owner and developer of the property, uses the "Trump" name and mark under license from Trump Marka Hollywood LLC, which license may be terminated or revoked according to its terms. Trump Hollywood is a trademark and/or registered trademark of Donald J. Trump.



HOLLYWOOD REDEFINED



Oceanfront Luxury
Condominium Residences
A Donald J. Trump Signature Property

Welcome to the new definition of luxury
Welcome to Trump Hollywood®

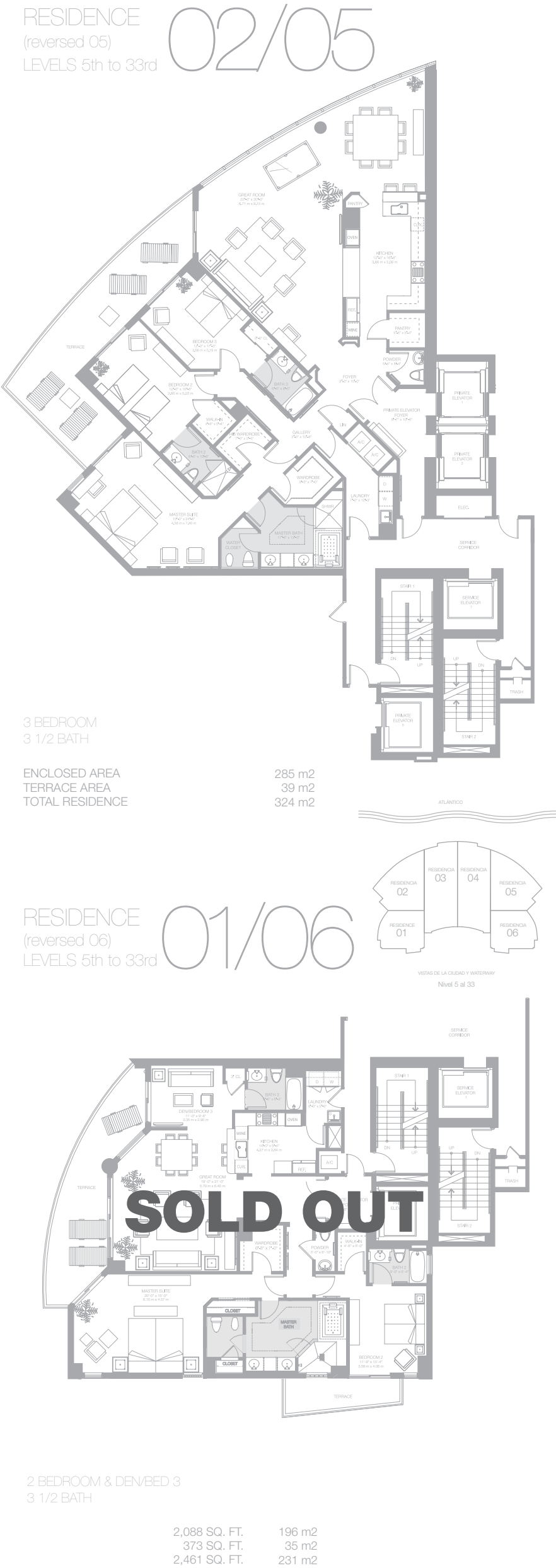

Trump Hollywood Lobby



Trump Hollywood Club Room



Trump Hollywood Library/Private Dining Room



Trump Hollywood Wine Room



BUILDING AMENITIES

- Direct oceanfront location on 240 feet of Hollywood's magnificent sandy beaches
- 4.9 acre site straddling South Ocean Drive with both Atlantic Ocean and Intracoastal frontage
- Exclusive 41-story tower with 200 spacious residences
- Lushly landscaped entry plaza with elegant porte-cochere entrance and stunning water display
- Common area amenities include a clubroom with multimedia facilities, billiards and game room
- 4,000 sq ft state of the art fitness center with men and women's steam and sauna facilities
- Home theater
- Wine Cellar and tasting salon
- Lavish Cigar lounge with private humidor
- Breakfast Café
- Library/Private Dining Room with a state of the art catering kitchen
- Elevated pool deck overlooking the Atlantic Ocean featuring a pool side café, heated pool, two spas, and a reflecting pool
- Beach and pool attendant with towel service
- Two levels of beachfront private cabanas
- Private poolside cabanas
- Secure air-conditioned storage spaces
- Three lighted tennis courts and one multi purpose court
- Exclusive concierge staff and services
- 24-hour complimentary valet parking
- 24-hour attended security services
- Wireless internet capabilities in the building's common areas
- Within walking distance to the Diplomat Landing and Hollywood Broadway
- Close proximity to the Hollywood/Fort Lauderdale International and Miami International airports

RESIDENCE FEATURES

- FOB operated high-speed elevators to individual private elevator foyers
- Service elevators to separate service entrance for each residence through service corridor
- Elegant double entry doors leading to spacious foyer with coffered ceilings
- Flow-through floor plans with panoramic views of Ocean, Intracoastal and City as well as wrap around views from select residences
- Impact resistant floor-to-ceiling tinted glass walls throughout
- Oversized terraces with glass & aluminum railings
- Floor to ceiling impact resistant sliding glass doors to terraces
- Nine-foot ceiling height in living spaces on floors 5 to 33
- Ten-foot ceiling height in living spaces on floors 34 to 40
- Eleven-foot ceiling height in living spaces on penthouse floor
- Smooth finish plaster and drywall ceilings
- Spacious walk-in closets
- High-efficiency central air conditioning and heating system
- The latest in "Smart Building" technology through Apple's iTouch, linking residents to building amenities

THE DEVELOPERS

Development partners BH3 and The Related Group proudly present Trump Hollywood, the premier architectural landmark on Hollywood Beach. Trump Hollywood elevates the very concept of exclusive condominium living. Superlative design, distinctive amenities and peerless service are masterfully integrated in the finest setting on the South Florida Gold Coast.

In keeping with the superior quality of the property, The Developers are proud to associate the property with the Trump name and brand through an exclusive licensing agreement with Trump Marks Hollywood LLC. To the discerning buyer, Trump branding signifies the highest standards of luxury, quality and service in premier real estate developments throughout the world.



Trump Hollywood Oceanfront Pool Deck



Trump Hollywood Lobby
"The Reflective Forest" by Sawada Hirotochi

Stated dimensions are measured to the exterior boundaries of the exterior walls and the centerline of interior demising walls and in fact vary from the dimensions that would be determined by using the description and the definition of the "Unit" set forth in the Declaration (which generally only include the interior airspace between the perimeter walls and excludes interior structural components). Additionally, measurements of rooms set forth on any floor plan are generally taken at the greatest points of each given room (as if room were a perfect rectangle), without regard for any cutouts. Accordingly, the area of the actual room will typically be smaller than the product obtained by multiplying the stated length times width. All dimensions are approximate and all floor plans and development plans are subject to change.